

CONDOR

2026 Class B Motorhome

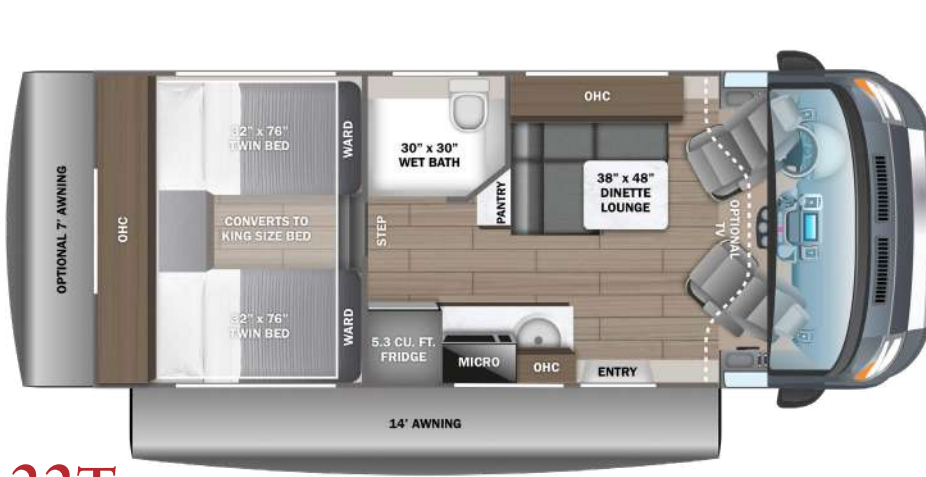

22T

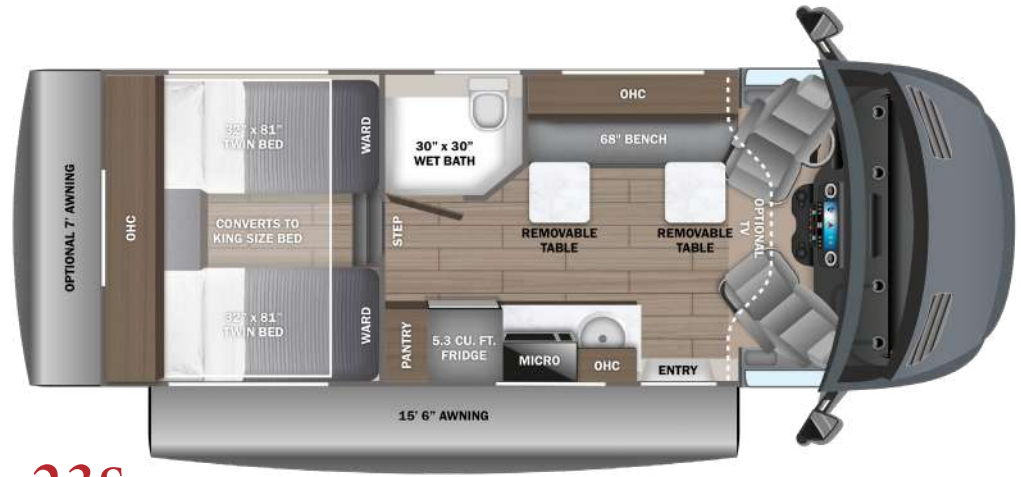

23S



PAINT SELECTIONS



Standard Graphics



Black Hills Full-Body Paint



Conifer Full-Body Paint



Graphics Delete Option



Magnet Full-Body Paint



Sandy Oak Full-Body Paint

CUSTOMER VALUE PACKAGE

E-Z Drive™: Computer-balanced driveshaft, heavy-duty rear stabilizer bar, standard front stabilizer bar and Hellwig® helper springs (22T)
 One-piece, seamless, fiberglass front cap
 3.9kWh lithium battery (12V with 310 amp-hr)
 2,000W inverter
 360W roof mounted solar panel with dual controller
 Expandable side port with second dual bank controller for solar
 Backup camera
 Aqua View® SHOWERMISER™ water management system
 Internal holding tanks

STANDARD CHASSIS EQUIPMENT

Chassis Equipment for 22T

Ford® Transit 350HD AWD chassis
 156 in. wheelbase
 GVWR - 11,000 lb.
 GCWR - 15,000 lb.
 3.5L EcoBoost V6 310 HP engine with 400 ft.-lb. torque
 10-speed transmission
 205/75R16C all-season tires
 3.73 limited slip axle
 (2) 12V AGM chassis batteries (70 amp-hr)
 31 gal. fuel tank (gas)
 12 in. SYNC 4 HD/NAV/IACC multi-function display
 4-way swivel driver and passenger seats
 Tilt and telescoping steering wheel
 Intelligent adaptive cruise control
 Lane-keeping system
 Forward collision warning
 Pre-collision assist with automatic emergency braking (AEB)
 Post-collision braking
 SOS Post Crash Alert System™
 Safety Canopy® side-curtain airbags
 Ford® AdvanceTrac® with RSC® (roll stability control)
 Side wind stabilization
 SecuriLock® passive anti-theft system with engine immobilizer
 Autolocking drive away with crash unlocking
 Remote keyless entry
 FordPass™ Connect
 Tire pressure monitoring system (TPMS)
 Daytime running headlamps
 Wiper-activated headlamps

Chassis Equipment for 23S

Premium Mercedes-Benz® 3500 AWD chassis
 170 in. wheelbase
 GVWR - 11,030 lb.
 GCWR - 15,250 lb.
 2.0L inline 4-cylinder Twin Turbo 211HP diesel engine with electronic fuel injection with 332 ft.-lb. torque
 9-speed transmission

All-terrain tires
 (1) 12V AGM chassis batteries (70 amp-hr)
 26.4 gal. fuel tank (diesel)
 5.8 gal. DEF tank
 10.25 in. integrated Mercedes-Benz® MBUX infotainment center
 Heated power swivel driver/passenger seats
 Leather-wrapped tilt steering wheel with integrated controls
 Smartphone tray with wireless charging
 Active Distance Assist DISTRONIC®
 Active lane keeping assist
 Crosswind assist
 Active brake assist
 Traffic sign assist
 Attention assist
 Breakdown management
 Emergency call system

Chassis Equipment on All Floorplans

250-amp alternator
 Power anti-lock brakes with power steering
 Power-adjusting, heated side-view mirrors
 Driver and passenger airbags
 Hill start assist
 Rain-sensing wiper system
 Automatic high-beam headlights
 Power windows and door locks
 Privacy shades for cab windows

STANDARD EXTERIOR EQUIPMENT

TuffShell™ vacuum-bond laminated roof, floor and sidewalls
 Bead-foam insulation (R-24 max roof, R-9 max floor, R-8 max walls)
 One-piece, seamless, fiberglass roof
 Fiberglass exterior walls with partial paint and vinyl graphics
 Dual-pane acrylic windows
 Heated rear garage
 (28 in. x 81 in. x 43 in. on 22T; 34 in. x 81 in. x 43 in. on 23S)
 L-track, (2) 120V charging ports and (1) 12V charging port in garage
 Molle panels in garage (23S)
 Electric patio awning with auto-retract and LED lights
 Roof rack (23S - N/A with pop-top option)
 Collapsible exterior ladder (23S)
 Matte black aluminum wheels
 Chrome grille (23S)
 Cable TV hookup with RG-6 coax
 Starlink satellite internet system (23S)
 Winegard® Connect 2.0 4G/Wi-Fi/digital TV antenna
 2,800W gas generator with auto-gen start (22T)
 2,500W LP generator with auto-gen start (23S)
 30-amp electrical service with detachable power cord
 120V exterior outlet
 6 gal. propane tank (20 lb.) (22T)
 6 gal. (20 lb.) and 12.2 gal. (41 lb.) propane tanks (23S)
 LP quick-connect hookup

LED-lit holding tank valves
 Winterization drain system
 12V demand water pump
 Water filtration system
 Outside shower

STANDARD INTERIOR EQUIPMENT

Custom-molded ABS cab-over with storage
 Soft-touch vinyl ceiling
 High-intensity LED ceiling lights
 Residential vinyl flooring
 Firefly Multiplex system - wall-mounted touchscreen and mobile app for total coach control (mobile app available on 23S only)
 13,500 BTU air conditioner
 17,000 BTU Timberline Binar 5D hydronic heating system with LED touchscreen control
 Cassette screens and night shades
 JBL® Flip 6 removable wireless Bluetooth speaker (23S)
 Adjustable table with multiple mounts
 5.3 cu. ft. 12V refrigerator
 Soft-close cabinet doors and drawers
 Portable induction cooktop
 Convection microwave
 Stainless steel sink
 Pressed countertops
 (2) twin-size beds with filler cushion converts to king-size bed
 All-in-one wet bath with shower and cassette toilet
 Shower with curtain surround
 Powered roof vent in wet bath (N/A with pop-top option)
 Medicine cabinet with mirror
 Seatbelts for driver/passenger seats and select cab locations
 Smoke alarm
 Carbon monoxide detector
 Fire extinguisher

OPTIONS

Starlink satellite internet system (22T)
 32 in. Smart LED HD TV with cab and exterior mounts
 7 ft. rear awning
 Pull-out exterior kitchen
 Delete patio awning
 50.5 in. x 79.75 in. pop-top



At Entegra Coach, we build our RVs to handle every adventure, then back them with our industry-leading 2+3 limited warranty. Our 2-year limited warranty has you covered for 2 camping seasons. That's 730 days. In addition, our 3-year structural limited warranty has you covered for 3 camping seasons or 1,095 days. You won't find a better limited warranty in the business, because the only strings we attach are those that deliver the ultimate in reliability. For a copy of our 2-year limited + 3-year structural limited warranty with complete terms and conditions, please contact your local Entegra Coach dealer.

It is important for your safety and enjoyment that you are aware of the weights and tow ratings of the RV you select. Consult a competent advisor for questions or advice. Whether you are new to RVing or a veteran, get a feel for the performance of your RV before heading out on the roadways. When you tow a vehicle with your RV, you must drive differently than when you drive a single vehicle. Practice hooking up, driving, backing up and braking in a safe environment or seek out professional instruction. Jayco affixes a weight label to each RV which lists weight information for that vehicle. Refer to that label to verify the vehicle will meet your requirements. Gross Vehicle Weight Rating (GVWR): The maximum permissible weight of the motorhome, including the Unloaded Vehicle Weight (UVW) plus passengers, personal items, all cargo, fluids, options and dealer-installed accessories. The GVWR is equal to or greater than the sum of the UVW and the Cargo Carrying Capacity. Gross Combined Weight Rating (GCWR): The maximum allowable combined weight of the motorhome used as a tow vehicle and the attached towed vehicle.

Floorplan	GVWR (lbs.)	GCWR (lbs.)	Wheel Base	Overall Length	Exterior Height w/ A/C & Satellite	Exterior Width	Interior Height	Fresh Water Capacity (gal.)	Grey Waste Water Capacity (gal.)	Black Waste Water Capacity (gal.)
22T	11,000	15,000	156"	23' 5"	11' 1"	85"	80"	53	51	4.75
23S	11,030	15,250	170"	25' 2"	11' 3"	85"	80"	53	51	4.75



Entegra Coach, Inc., P.O. Box 460, Middlebury, IN 46540, www.entegracoach.com. See dealer for further information and prices. All information in this brochure is the latest available at the time of publication approval. Entegra Coach reserves the right to make changes and to discontinue models without notice or obligation. Photos in this brochure may show optional equipment and props for photography purposes. RVs built for sale in Canada may differ to conform to Canadian codes. ©2025 Entegra Coach, Inc. Printed in U.S.A. 2033073



LEGACY ISN'T LEFT, IT'S LIVED.